



MILEAGE SUMMARY

CLASS 2	6,680
TH-1	2,960
TH-2	3,440
TH-3	2,110
TH-4	0,750
TH-5	0,750
TH-6	2,030
TH-7	0,800
TH-8	2,200
TH-9	1,300
TH-10	0,140
TH-11	0,350
TH-12	0,090
TH-13	0,170
TH-14	
TOTAL CLASS 2	21,870
CLASS 3	69,94
TOTAL CLASS 3	69,94
TOTAL TOWN	91,810
STATE HIGHWAY	2,431
VT-2A	8,960
VT-15	1,361
VT-127	0,142
TOTAL STATE HIGHWAY	3,934
US HIGHWAY	2,196
US-2	8,960
US-7	0,142
TOTAL US HIGHWAY	9,156
TOTAL STATE	13,090
INTERSTATE	7,568
I-89	143,038
TOTAL INTERSTATE	7,568
INTERSTATE - Ramps	2,206
I-89	146,13
TOTAL INTERSTATE - Ramps	2,206
TOTAL INTERSTATE	9,774
TOTAL, TRAVELED HIGHWAYS, FEB. 10, 2014:	114,674

(Excludes Class 4, Legal Trail, and Undefined Corridor Mileage)

TOWN LENGTH IN MILES "NOT UP TO STANDARD"

HWY. No.	Length (Miles)
18	0.08
61	0.04
TOTAL	0.12

**The sections of the town highways listed above are legally Class 3, but have been deemed "Not Up To Standard" and are functionally Class 4 Town Highways*

LEGAL TRAIL LENGTH IN MILES

No.	Length (Miles)
1	0.39
2	0.09
TOTAL	0.48

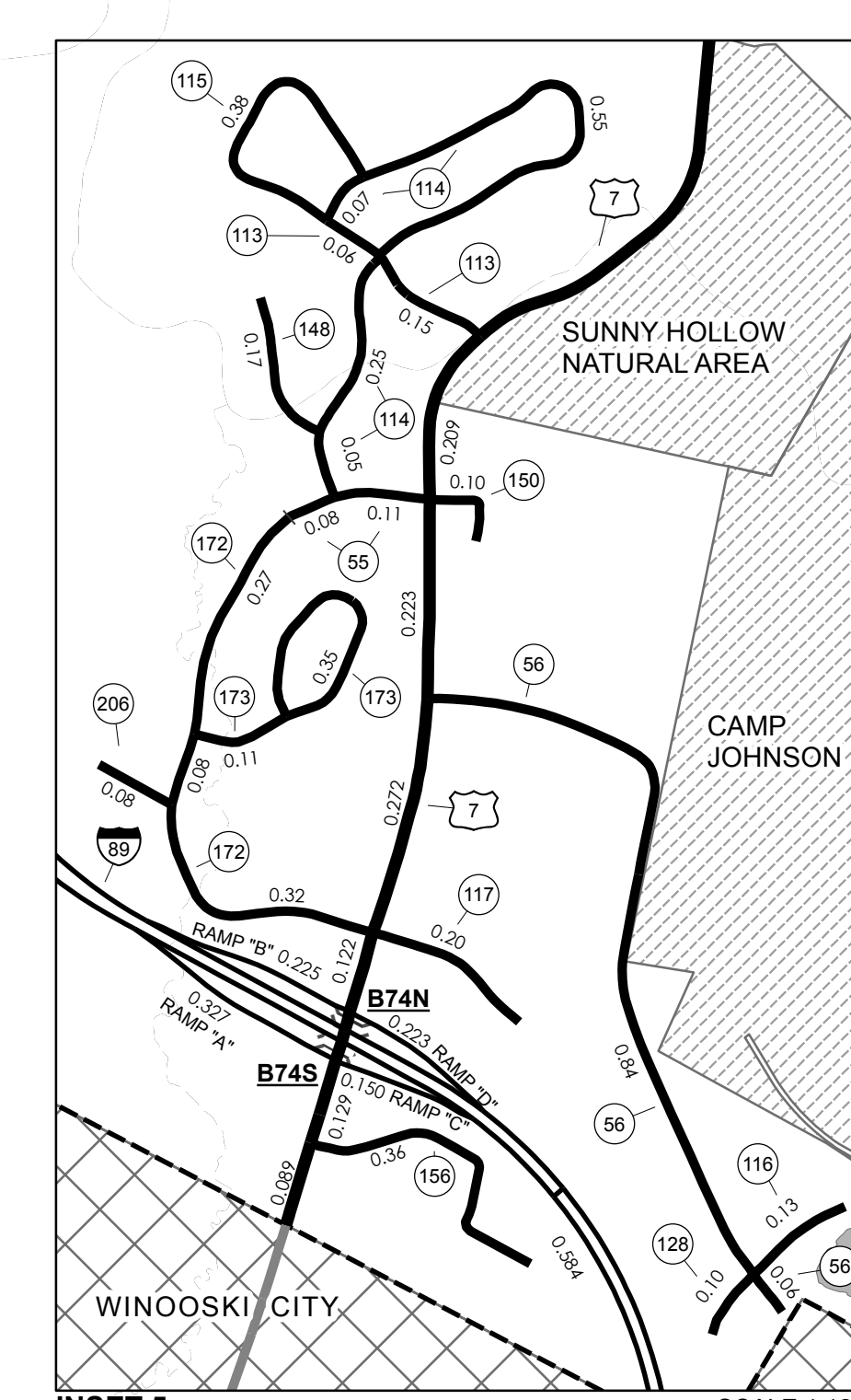
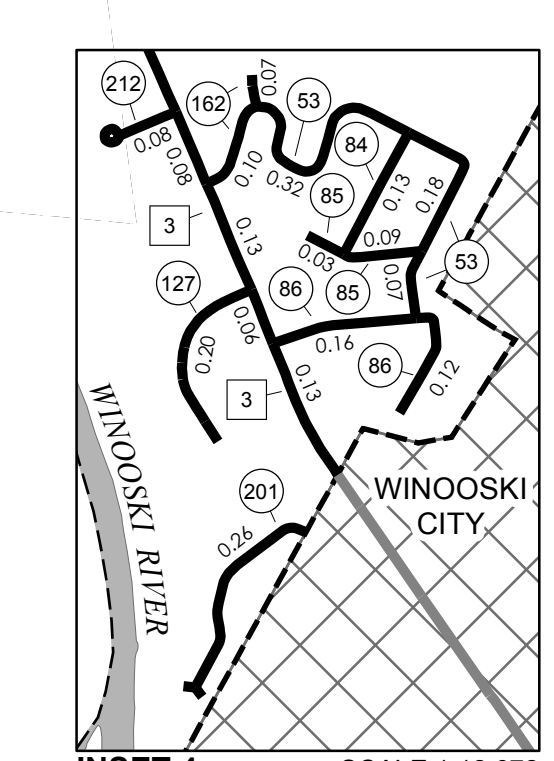
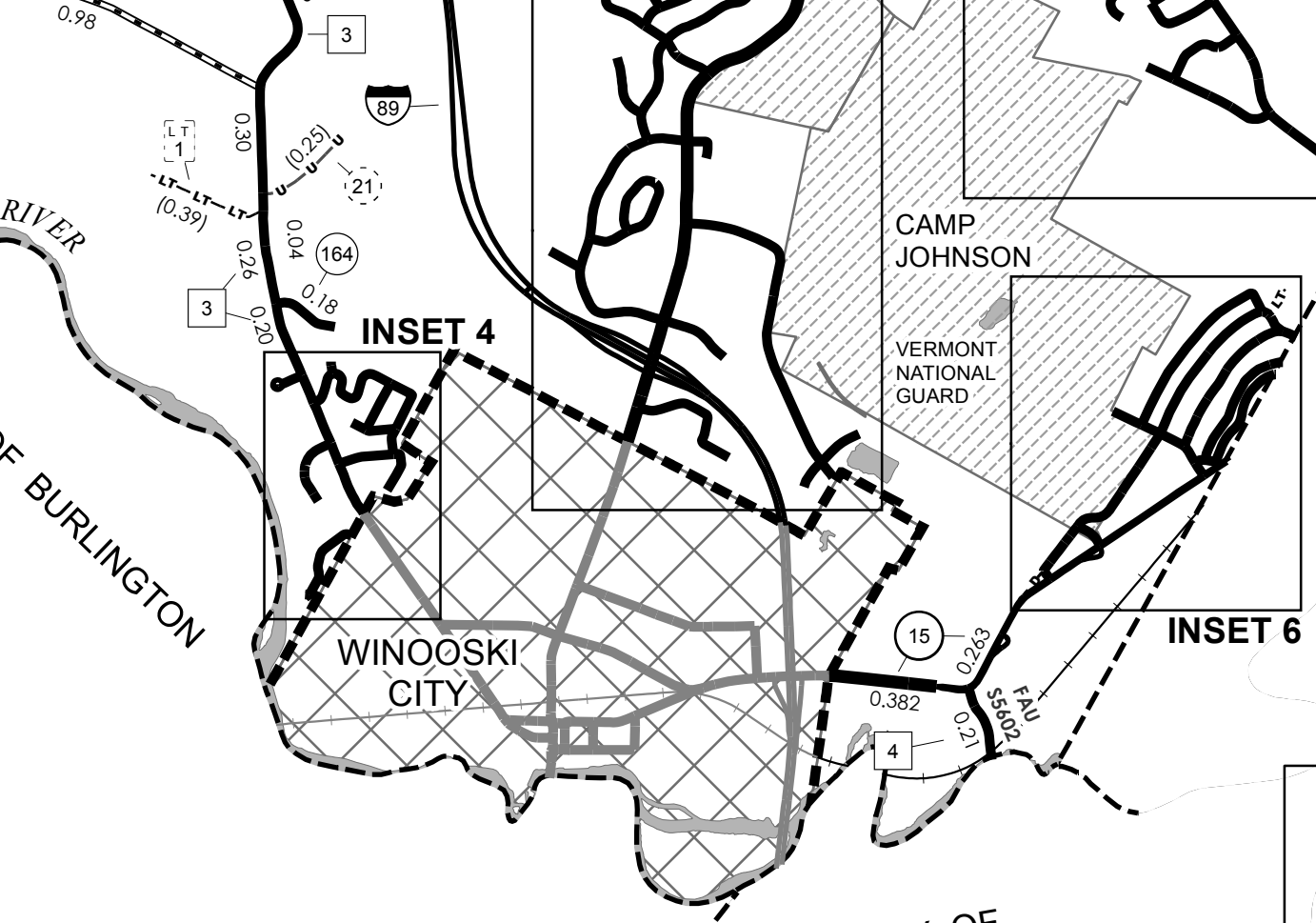
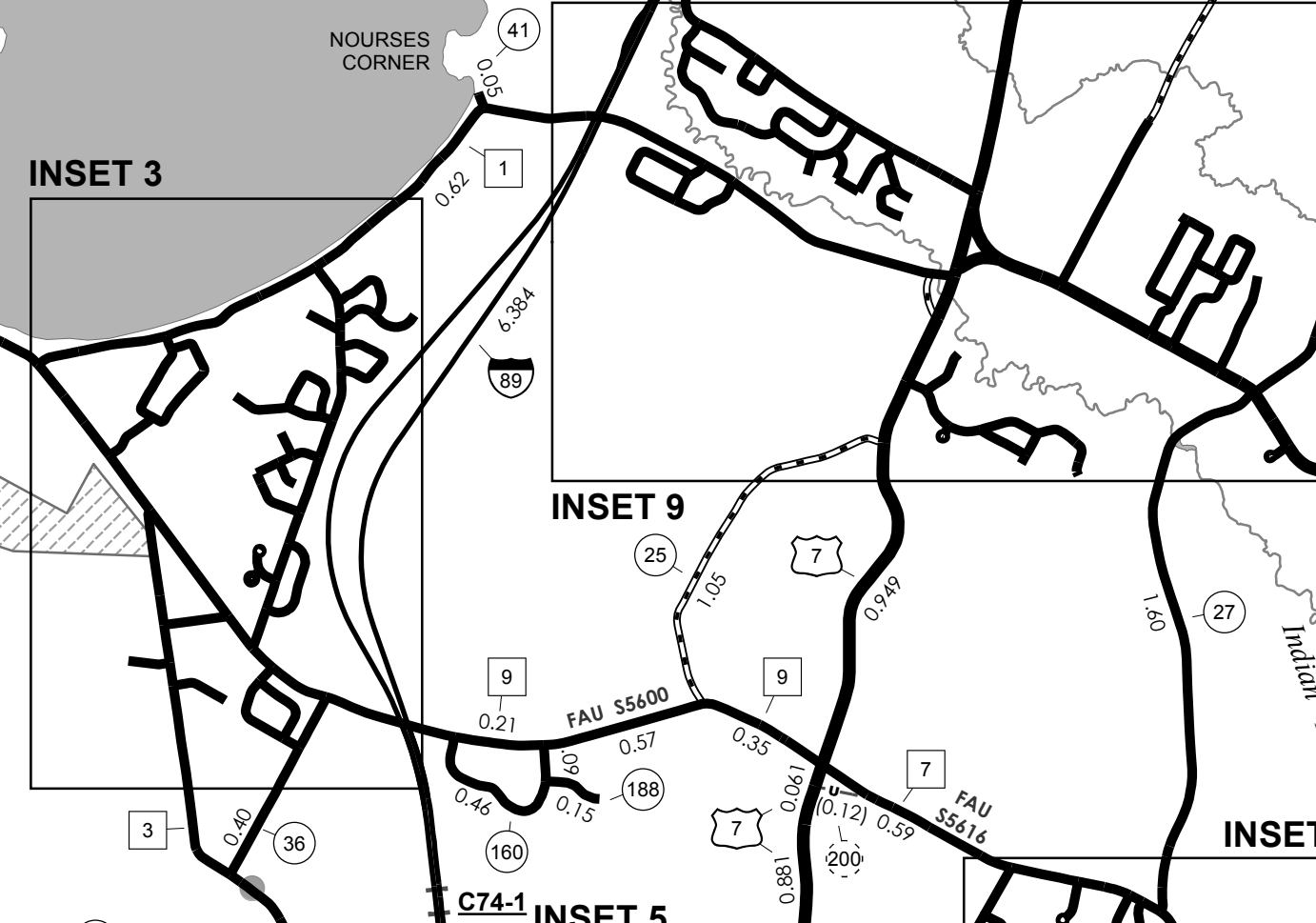
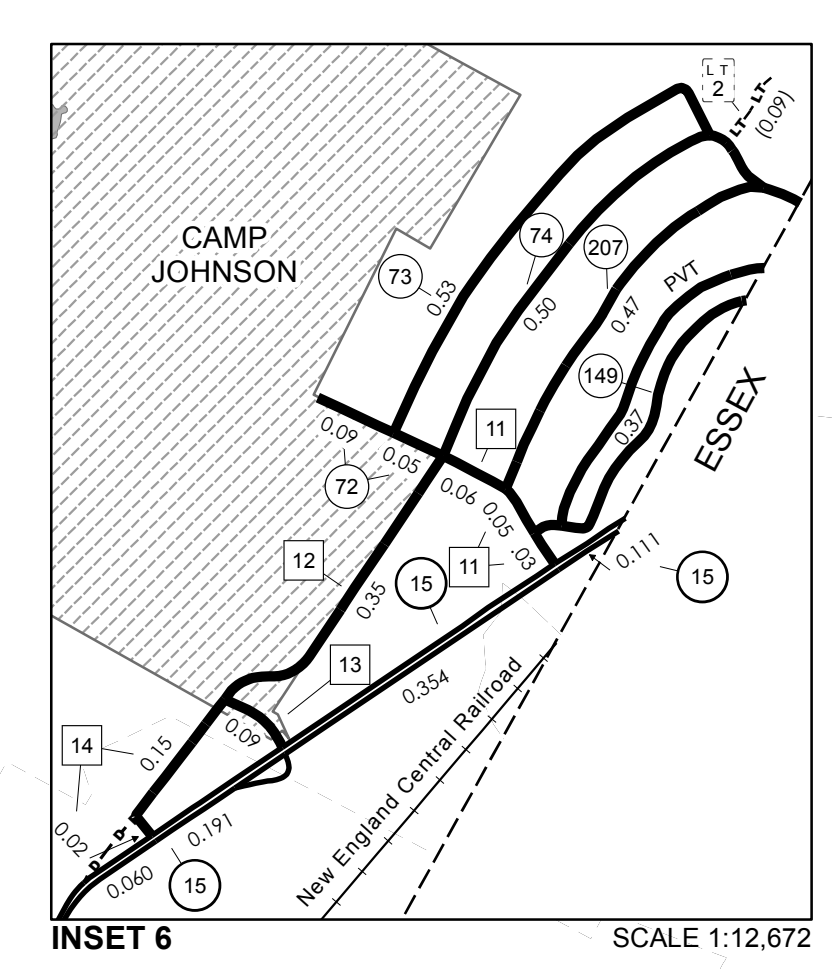
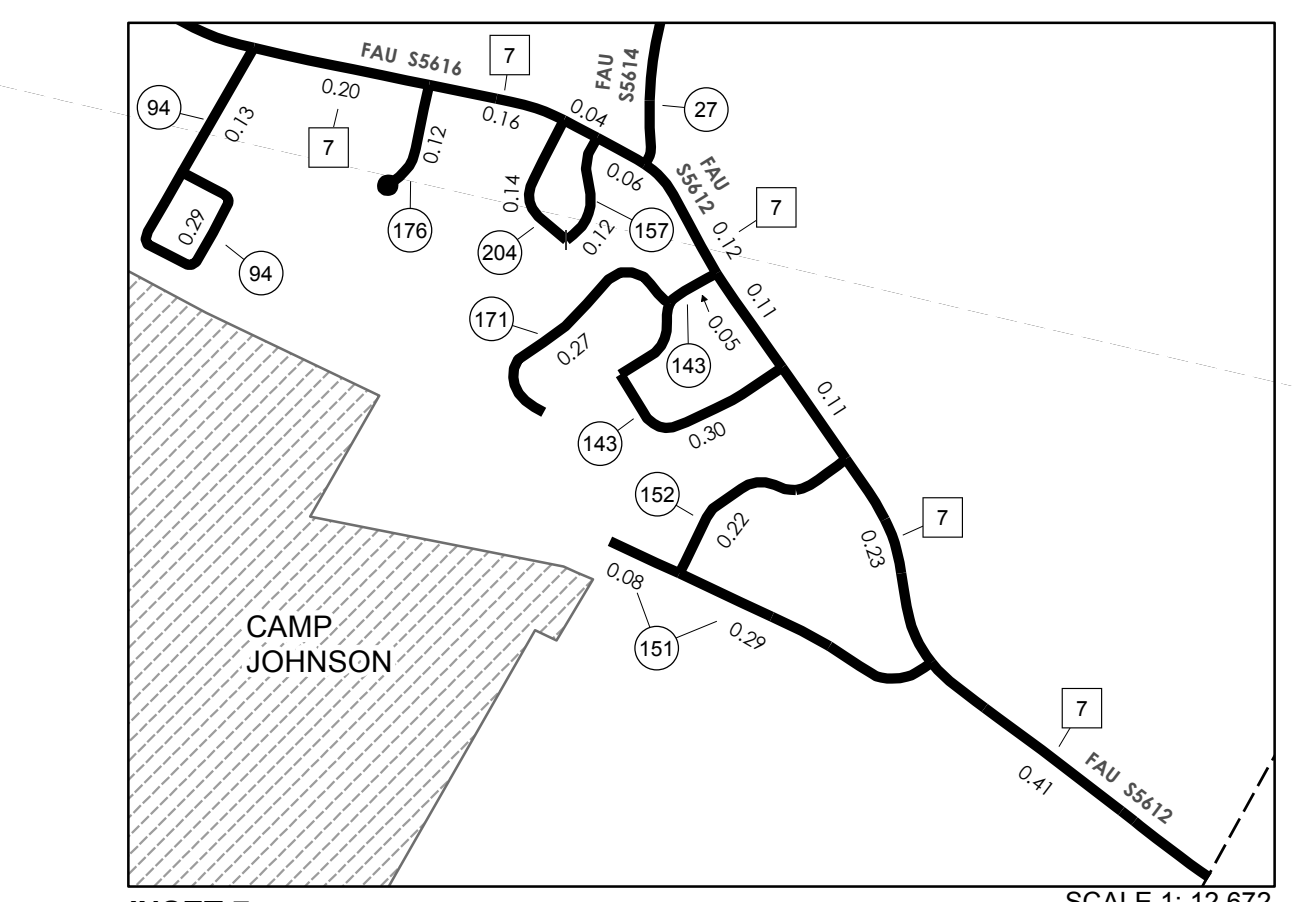
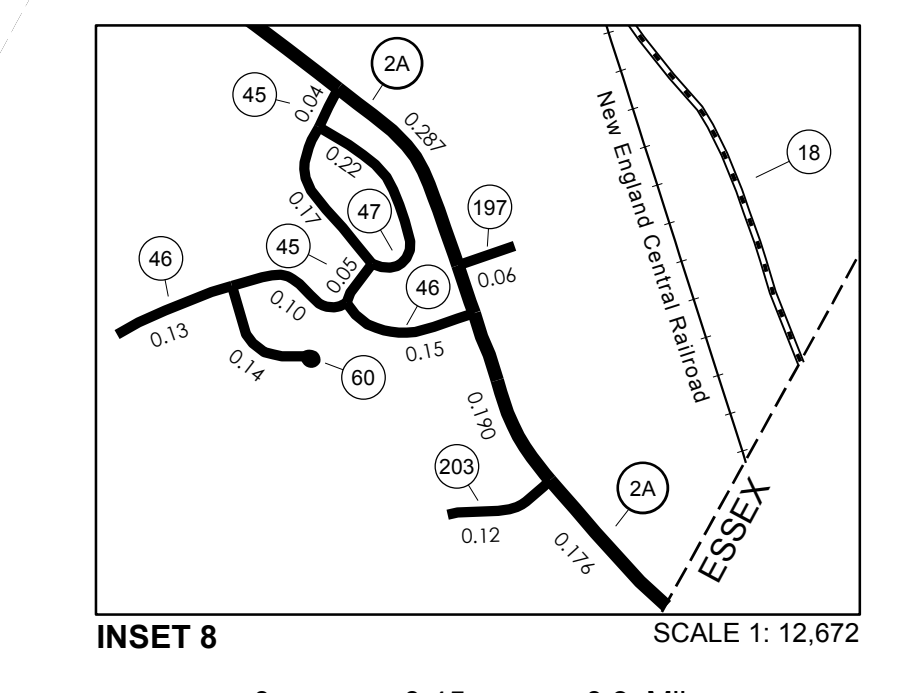
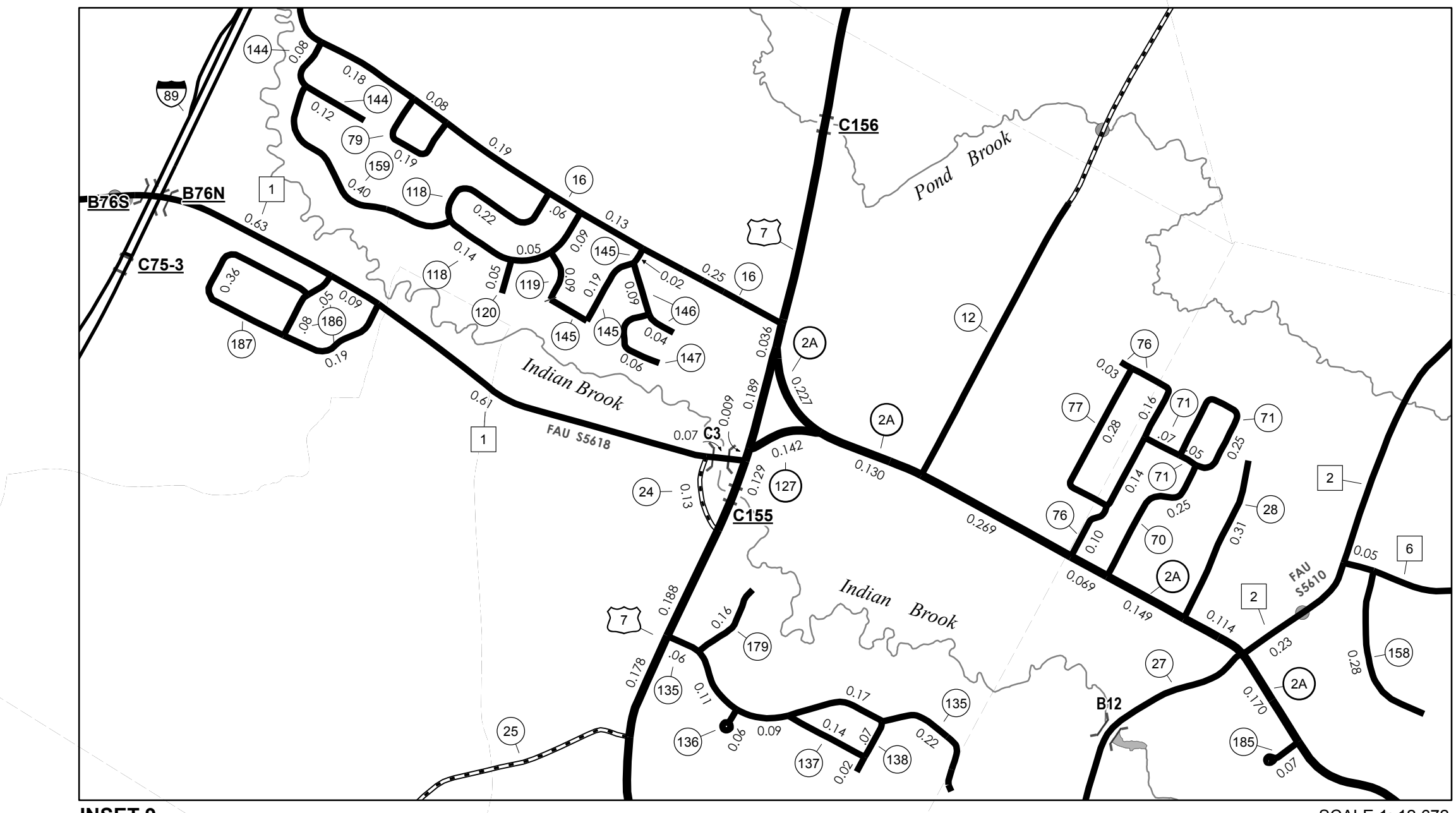
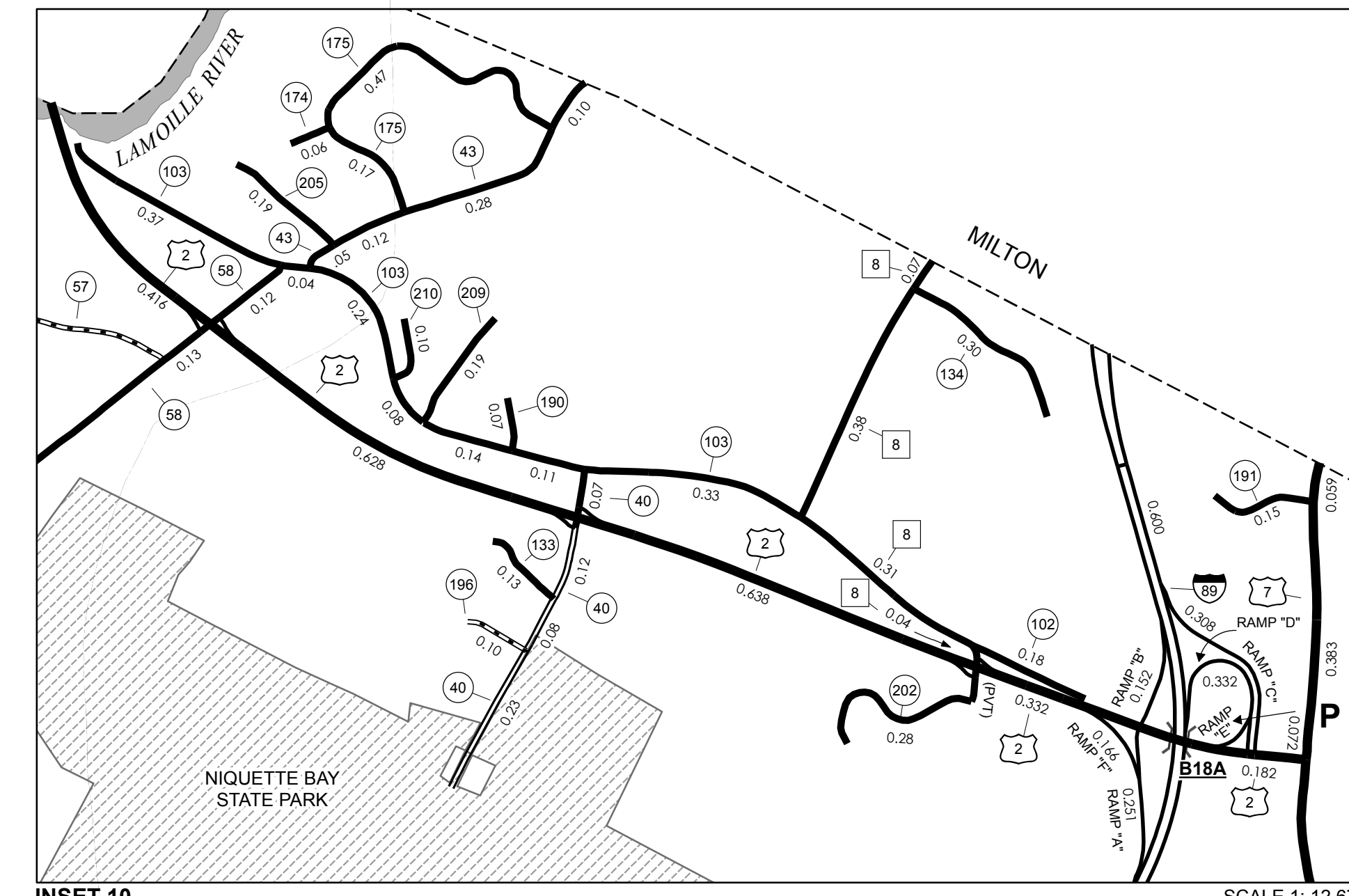
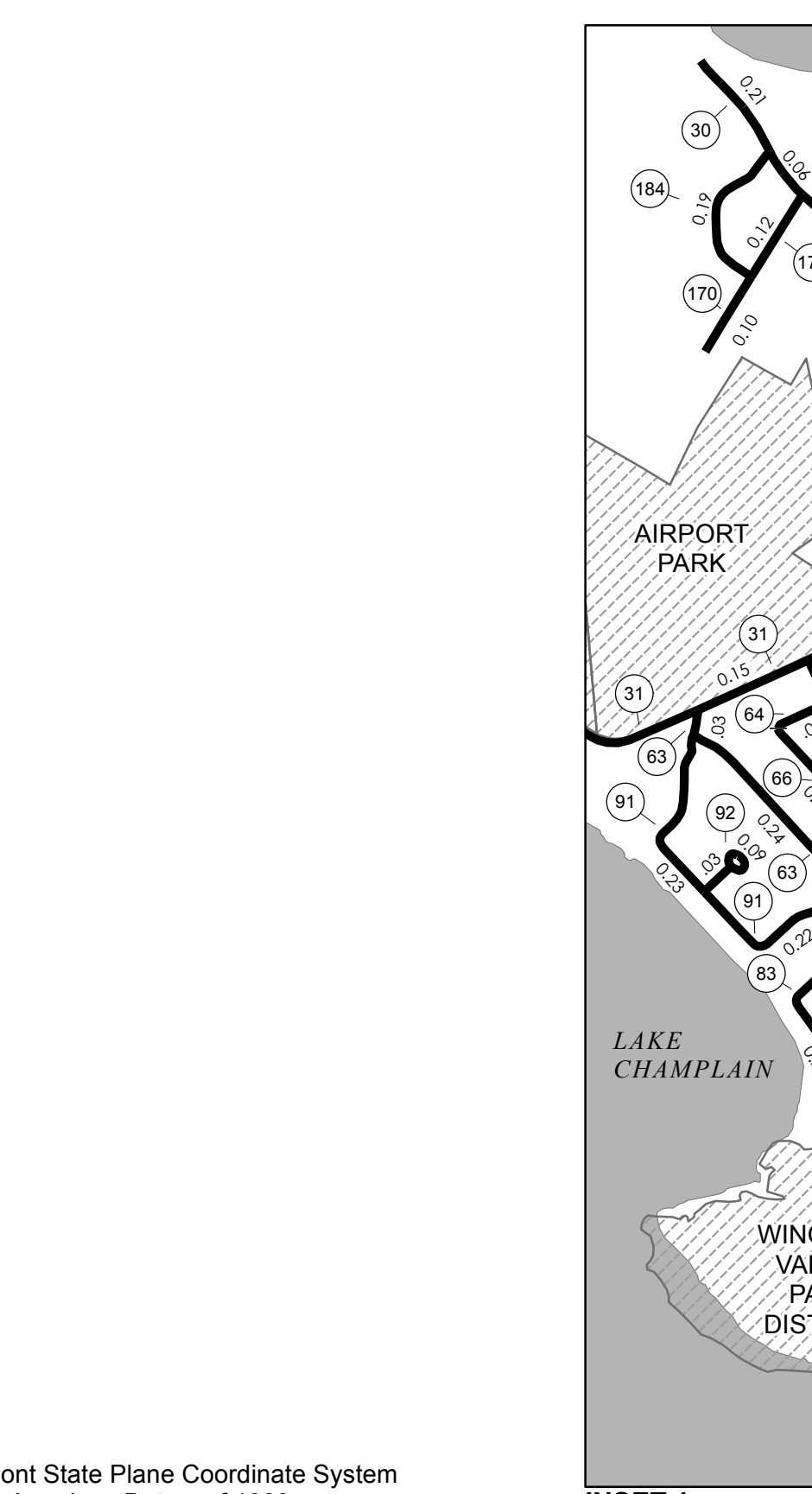
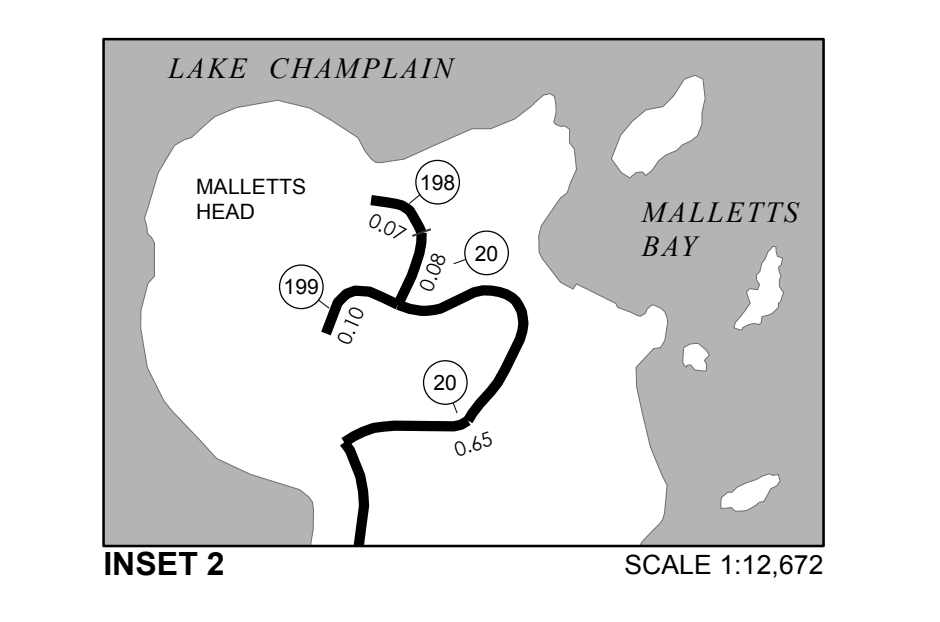

VERMONT GENERAL HIGHWAY MAP
Town of Colchester
 CHITTENDEN COUNTY
 Transportation District #5
 Prepared by the Vermont Agency of Transportation
 Division of Policy, Planning and Intermodal Development
 in cooperation with
 U.S. Department of Transportation
 Federal Highway Administration
 Mileage as of February 10, 2014
 Map prepared October 16, 2014
 SCALE 1:31,680

DISCLAIMER:
 The untraveled highways (laid-out town highways), discontinued highways, and legal trails hereon are those of which the Agency of Transportation has record; others may exist.
 Highway and bridge data by the Agency of Transportation. Town short structures are drawn from the Vermont Online Bridge & Culvert Inventory Tool (VOBCIT) database. All other data from the Vermont Center for Geographic Information. Only named streams are shown.